

LA-CAN

Controlador Wide Band para Sonda Lambda Bosch LSU 4.9 con comunicación CAN y USB-C

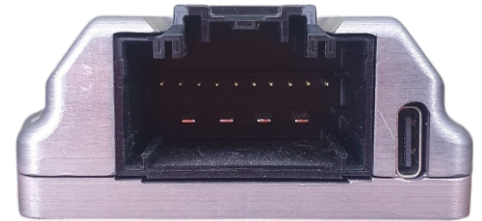

PIN	LA-CAN
1	Analog1
2	La1 P (IP)
3	Res Comp
4	IP (0V)
5	La 1 S (Nernst)
6	La Signal
7	CAN_P
8	CAN_N
9	Analog2
10	5V Aux
11	Heater-
12	Heater+
13	GND
14	+VIN



PIN	FUNCIONES	COLOR
1	La1 P (IP)	Amarillo
2	IP (0V)	Marron
3	Heater-	Blanco
4	Heater+	Bl-Ro
5	Res Comp	Gris
6	La1 S (Nernst)	Azul



PIN	FUNCIONES	COLOR
1	Gnd	Negro
2	Can Lo	Gr-Ne
3	Can Hi	Gr-Ro
4	12V	Rojo



PIN	LA-CAN	DESCRIPCIÓN	COLOR
1	GIN	AD IN	nc
2	LS_APE_IP	Pin 1 LSU	Amarillo
3	LS_RT_IA	Pin 5 LSU	Gris
4	LS_IPN_VM	Pin 2 LSU	Marron
5	LS_UN_RE	Pin 6 LSU	Azul
6	LS_SIG_OUT	Analog Out	nc
7	CAN_P	CAN+	Gr-Ro
8	CAN_N	CAN-	Gr-Ne
9	USB_P	USB+	Verde
10	USB_N	USB-	Bl-Ce
11	LS_H_UH-	Pin 3 LSU	Blanco
12	VIN	Pin 4 LSU	Bl-Ro
13	GND	0V	Negro
14	+VIN	12V	Rojo

LSU 4.9	COLOR
IP+ / La1 P	Rojo
Ipr / R Comp	
VS / IP- / 0V	Amarillo
VS+ / La1 S	Negro
Heater-	Blanco
Heater+ / 12V	Gris

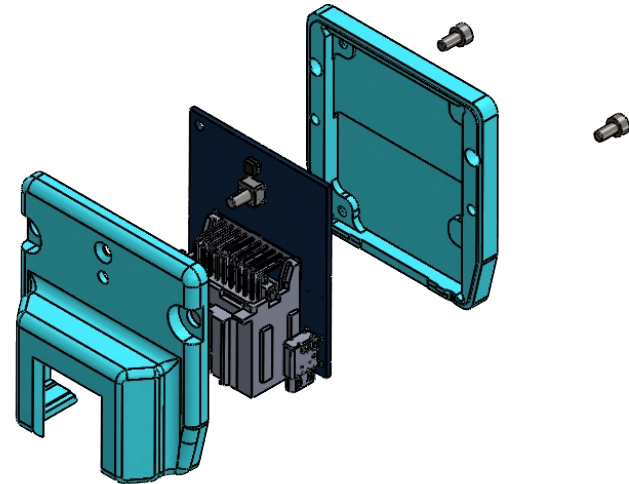
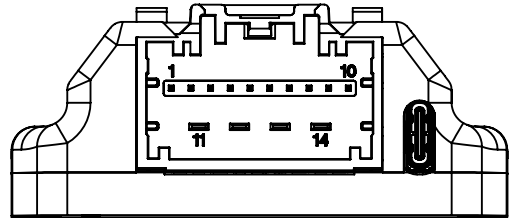
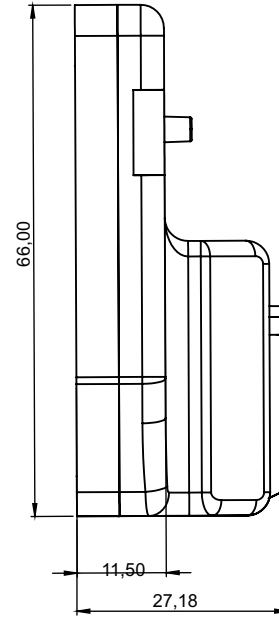
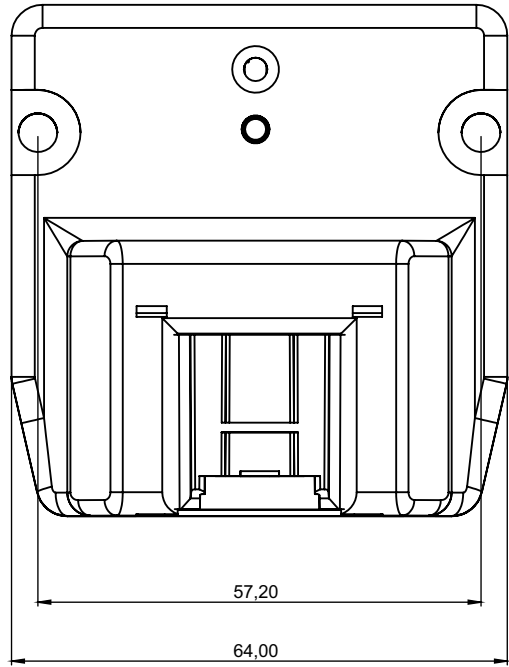

Tolerancia gral.	Escala		Denominación: LA-CAN Descripción: Controlador de sonda lambda	Nº Plan
Rugosidad gral.	Formato A2			
d1				
b				
Numero				